

Hijsbanden met triangels - Sangles de levage avec triangles acier - Lifting slings with triangles



BT / BTD

DUBBELE POLYESTERBAND MET TRIANGELS IN STAAL
 SANGLE POLYESTER DOUBLE AVEC TRIANGLES ACIER
 DOUBLE POLYESTER WEBSLINGS WITH TRIANGLES

CODE	BREEDE LARGEUR WIDTH (mm)	SWL-CMU SF.7:1				
Beige - Beige - Beige	BT/BTD 25	25	500 kg	1.000 kg	700 kg	400 kg
Paars - Mauve - Purple	BT/BTD 48	50	1.000	2.000	1.400	800
Graniet - Granit - Granite	BT/BTD 50	50	1.500	3.000	2.100	1.200
Groen - Vert - Green	BT/BTD 65	65	2.000	4.000	2.800	1.600
Geel - Jaune - Yellow	BT/BTD 75	75	3.000	6.000	4.200	2.400
Grijs - Gris - Grey	BT/BTD 100	100	4.000	8.000	5.600	3.200
Rood - Rouge - Red	BT/BTD 150	150	5.000	10.000	7.000	4.000
Bruin - Brun - Brown	BT/BTD 200	200	6.000	12.000	8.400	4.800
Blauw - Bleu - Blue	BT/BTD 250	250	8.000	16.000	11.200	6.400
Oranje - Orange - Orange	BT/BTD 300	300	10.000	20.000	14.000	8.000
Oranje - Orange - Orange	BT/BTD 4/200	200	12.000	24.000	16.800	9.600
Oranje - Orange - Orange	BT/BTD 4/250	250	15.000	30.000	21.000	12.000
Oranje - Orange - Orange	BT/BTD 3/300	300	16.000	32.000	22.400	12.800
Oranje - Orange - Orange	BT/BTD 4/300	300	20.000	40.000	28.000	16.000

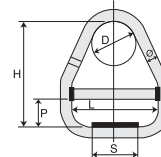
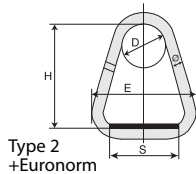
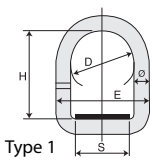
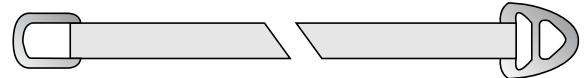
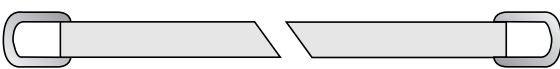
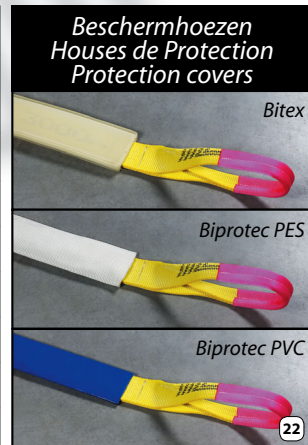

Staal - Acier - Steel:
 23 MnNiCrMo5.2
 (Din 17115)

TRIANGELS - TRIANGLES - TRIANGLES						
CMU/SWL		Dia*	D*	E*	H*	Kg
1 T	Euronorm	12	45	70	60	0,2
1,5 T	Type 2	14	25	84	80	0,33
2 T	Type 1	16	68	100	100	0,56
3 T	Type 2	18	84	120	120	0,84
4 T	Euronorm	23	60	179	130	1,64
5 T	Euronorm	26	90	222	180	2,16
6 T	Euronorm	28	90	262	180	2,97
8 T	Euronorm	32	100	344	200	5,82
10 T	Euronorm	35	100	400	250	7,87
16 T	Type 2	45	150	440	250	14,4

Labelprotection



DOORSTEK TRIANGELS - TRIANGLES COULISSANTS - TRIANGLE & CHOKER							
SWL		Dia*	D*	L*	P*	H*	Kg
1 T	Euronorm	12	50	80	25	100	0,37
1,5 T	Type 2	14	40	94	35	140	0,64
2 T	Type 1	16	60	110	46	168	0,98
3 T	Type 2	18	70	130	48	176	1,4
4 T	Euronorm	23	80	200	55	218	3,1
5 T	Euronorm	26	90	240	80	300	5,03
6 T	Euronorm	28	90	284	80	284	5,4
8 T	Euronorm	32	120	370	90	332	10,19
10 T	Euronorm	35	120	424	100	385	13,84
16 T	Type 2	45	150	460	120	466	27,2